



Blue Badge Disabled Parking for carriages, rickshaws, wheelchairs only

Hertford Road, East Finchley, N2

£650,000

 2 Bedrooms  1 Bathroom  1 Reception



Adam Hayes - East Finchley Office - Sales 158 High Road, East Finchley, London, N2 9AS
Tel: 0208 883 2621 Email: info@adam-hayes.co.uk Web: www.adam-hayes.co.uk

Hertford Road, East Finchley, N2

£650,000

 2 Bedrooms  1 Bathrooms  1 Receptions

Key Features

- Two Bedrooms
- First Floor
- Modern Kitchen
- Chain Free
- County Road
- Close to Amenities

Other Information

Tenure: Share of Freehold
Length of Lease: 999 Years
Ground Rent: Nil
Service Charge: Nil
Council Tax Band:



Nearest Stations

East Finchley Station 0.4 miles
Highgate Station 1.3 miles
Finchley Central Station 1.3 miles

Property Description

Situated in this popular tree lined road off East Finchley High Road is this two double bedroom first floor conversion, offered for sale on a chain free basis with vacant possession. The property comprises a bright reception room, a separate fitted kitchen, two well-proportioned double bedrooms and a family bathroom, offering spacious and well balanced accommodation throughout.

Conveniently located within easy reach of East Finchley Underground Station (Northern Line), local shops, cafés and amenities, as well as the open green spaces of Cherry Tree Wood. To really appreciate the size, location and potential, an internal viewing is highly recommended via vendors sole agents Adam Hayes Estate Agents.

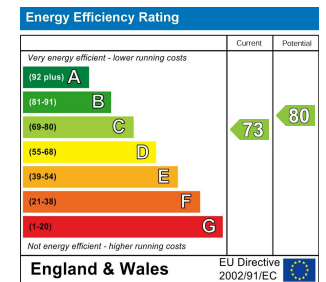

Adam Hayes - East Finchley Office - Sales 158 High Road, East Finchley, London, N2 9AS

Tel: 0208 883 2621 Email: info@adam-hayes.co.uk Web: www.adam-hayes.co.uk

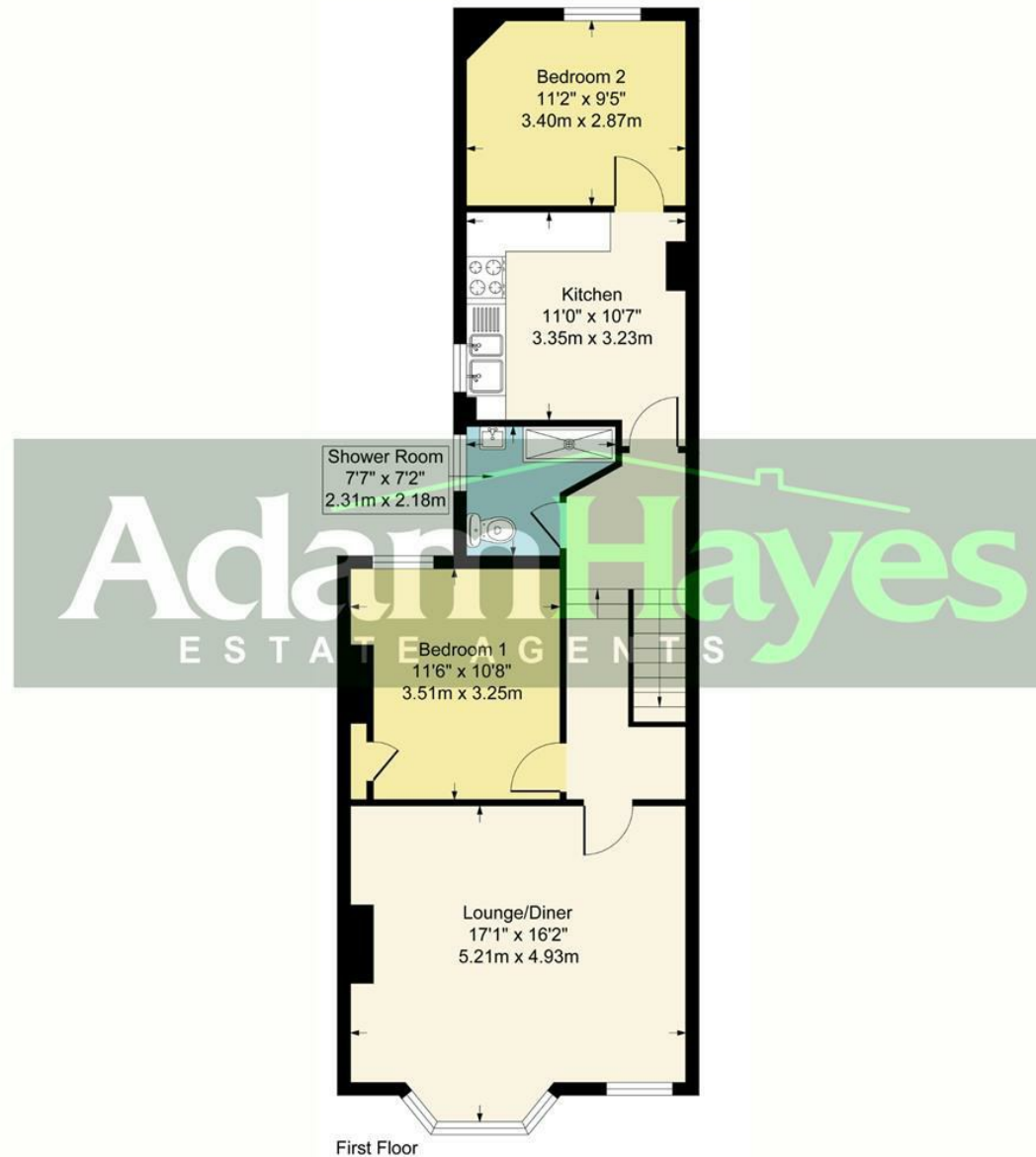

These particulars, whilst believed to be accurate, are set out as a general outline only for guidance and do not constitute any part of an offer or contract. Intending purchasers or prospective tenants should not rely on them as statements or representation of fact, but must satisfy themselves by inspection or otherwise as to their accuracy. We have not carried out a detailed survey, not tested the services, appliances and specific fittings. Room sizes should not be relied upon for carpets and furnishings. The measurements given are approximate. No person in this firm's employment has the authority to make or give any representation or warranty in respect of the property.